

PROJECT SK-230336		EXISTING HV & LV CIRCUIT LAYOUT	
NSLV-PAK KONG DD222 LOT1139 RP		DRAWING NO. 4	

Scale: 1:500	Date of print: 19-JUN-2023
Map No: 07SE15C	07SE15D

Remarks:

Map data reproduced with permission of the Director of Lands. (C) Hong Kong. Reproduction in any form must be approved by CLP Power.

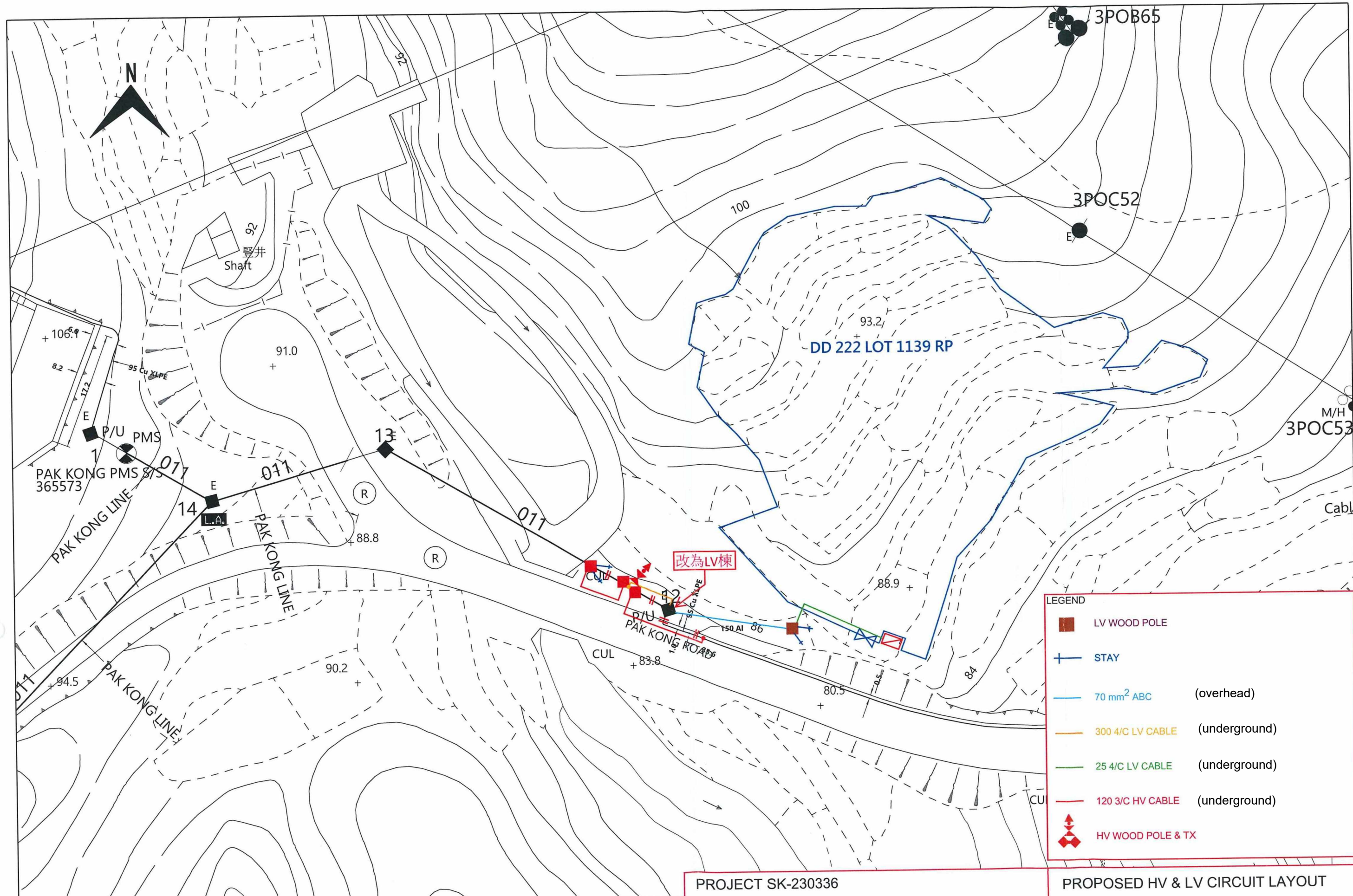

PROJECT SK-230336
 NSLV-PAK KONG DD222 LOT1139 RP
 PROPOSED HV & LV CIRCUIT LAYOUT
 DRAWING NO. 5

Scale: 1:500
 Date of print: 13-SEP-2023
 Map No: 07SE15C 07SE15D

Remarks:

Map data reproduced with permission of the Director of Lands. (C) Hong Kong. Reproduction in any form must be approved by CLP Power.